





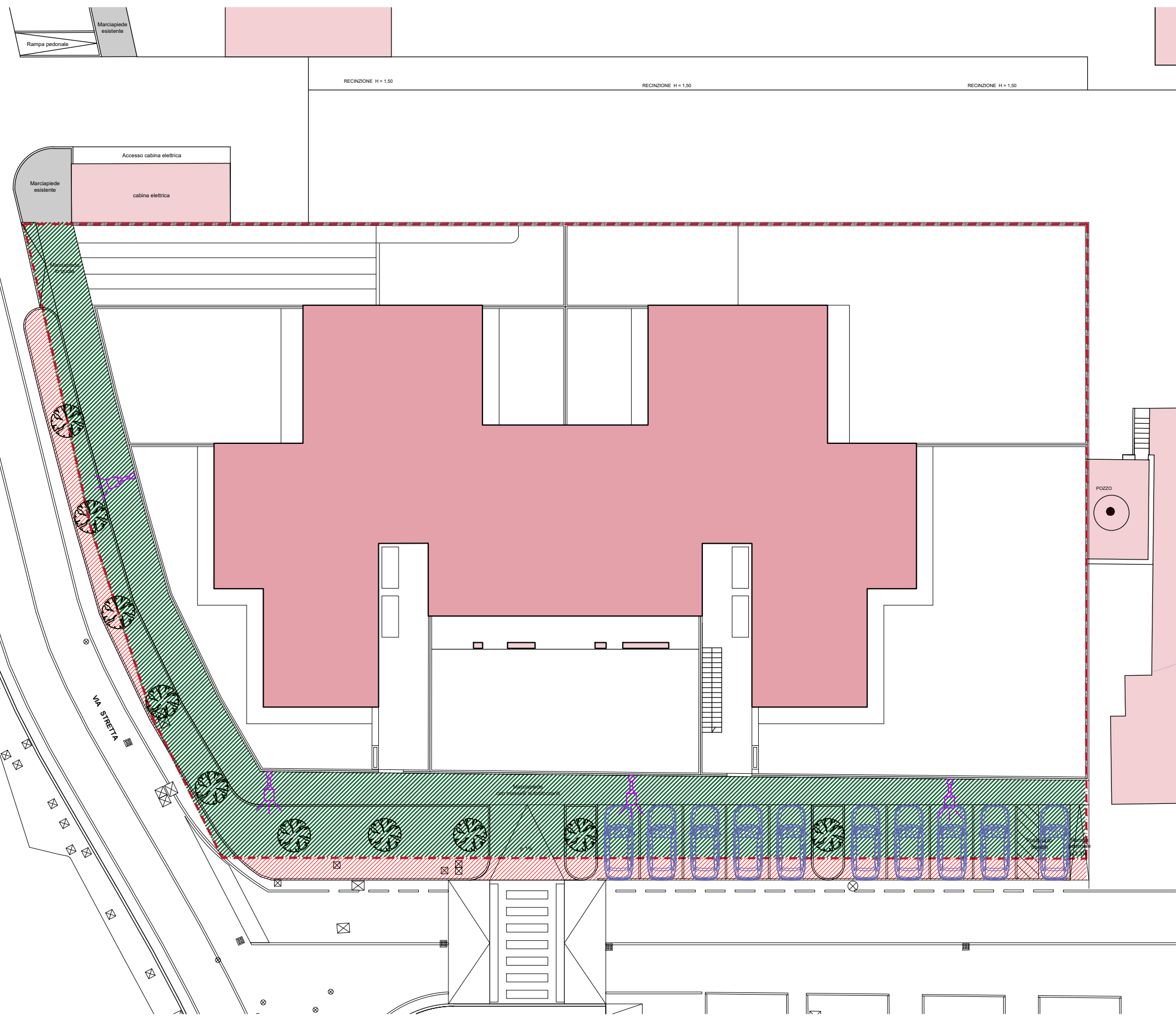

-  Confine area di proprietà
-  Percorso pedonale pubblico  
190,70 m<sup>2</sup>
-  Verde di arredo  
146,50 m<sup>2</sup>
-  Parcheggio pubblico  
121,15 m<sup>2</sup>
-  Area di proprietà da cedere  
378,82 m<sup>2</sup>
-  Area pubblica  
93,51 m<sup>2</sup>



**Planimetria urbanizzazioni**  
**Regime delle aree - scala 1:250**